

INSTRUCTION MANUAL

Exclusive Nozzle for ER-VS01

Conductive tube joint nozzle

ER-VAJT-64

1 OUTLINE

- This product is the exclusive nozzle for the ultra-compact ionizer spot type (ER-VS01).
- In order to use this product, the conductive tube (ER-AT50) (optional) is required.

2 SPECIFICATIONS

Designation	Conductive tube joint nozzle
Item	Model No. ER-VAJT-64
Air pressure range	0.02 to 0.7MPa (Max. applicable pressure depends on the tube length. Refer to the right figure)
Material	Stainless steel
Consumption air flow	20 to 160 ^l /min. (ANR) (at applied pressure of 0.02 to 0.7MPa)
Accessories	Attachment (White): 1pc., Resin tube: 1pc.

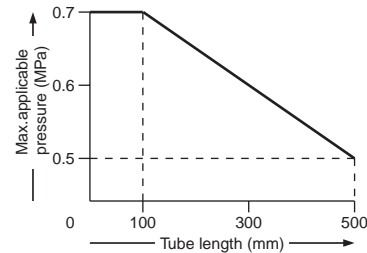

3 MOUNTING

- On the ultra-compact ionizer spot type (ER-VS01), a protective film is affixed on the nozzle fitting part. Be sure to remove it before fitting the nozzle.
- The resin tube and the attachment are enclosed with the nozzle. Mount them as described below.

Procedure

- ① Insert the resin tube into the center of the nozzle (ER-VAJT-64).
- ② Direct the convex part of the center of the attachment towards you (see the right figure) and inserted it into ER-VS01.
- ③ In the state of ①, insert them into the nozzle fitting part of ER-VS01.
- ④ Mount the nozzle into the nozzle fitting part of ER-VS01. The tightening torque should be 6N·m or less.
- ⑤ Insert the conductive tube (ER-AT50)(optional) into the one-touch joint section of the nozzle.

Note: Be sure to fit the resin tube and the attachment.

When they are not fitted, the static removal efficiency deteriorates considerably.

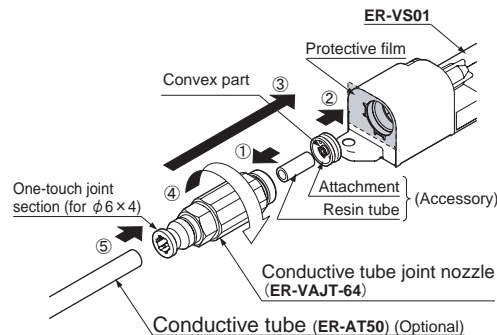

4 CAUTIONS

- Use the product by the air pressure according to the tube length.
- The static removal efficiency depends upon the air pressure value. Use the product by the appropriate air pressure.
- The longer the conductive tube (ER-AT50), the less effective the static removal efficiency. Cut off the tube at the desired length to meet your conditions for use.
- Use an attachment suitable for nozzle.
- The conductive tube (ER-AT50) is consumables. Replace it when fading or cracking etc. due to deterioration is found.

Thank you very much for using SUNX products. Please read this Instruction Manual carefully and thoroughly for the correct and optimum use of this product. Kindly keep this manual in a convenient place for quick reference.

5 OPTIONAL

● Conductive tube

Item	Model No.	ER-AT50
Length		500mm (cuttable at desired length)
Outer diameter × inner diameter		φ6 × 4mm
Minimum bending radius		15mm
Material		Urethane

6 DIMENSIONS (Unit: mm)

● ER-VAJT-64

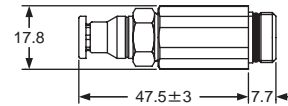

● Mounting drawing with ER-VS01

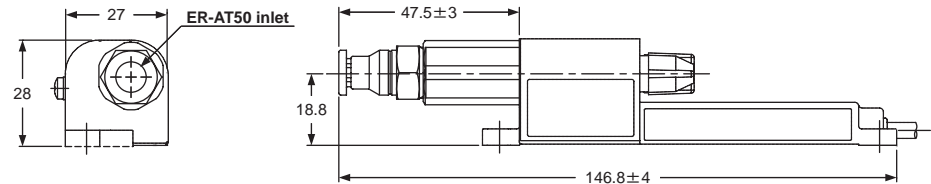
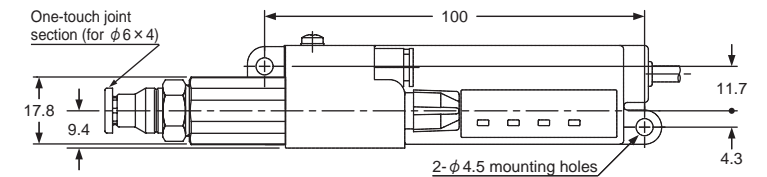

● Conductive tube holder

Item	Model No.	ER-ATH
Description		This is used for fixing the tip of the conductive tube (ER-AT50).

Note: For details, refer to the instruction manual enclosed with the conductive tube holder.

SUNX Limited

<http://www.sunx.co.jp/>

Head Office

2431-1 Ushiyama-cho, Kasugai-shi, Aichi, 486-0901, Japan

Phone: +81-(0)568-33-7211 FAX: +81-(0)568-33-2631

Overseas Sales Dept.

Phone: +81-(0)568-33-7861 FAX: +81-(0)568-33-8591